

# CSM 150/300

Conduction-cooled capacitor

Technology Patented Worldwide

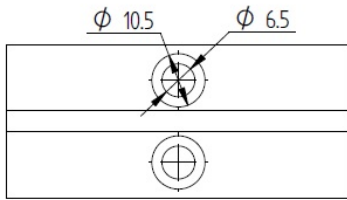
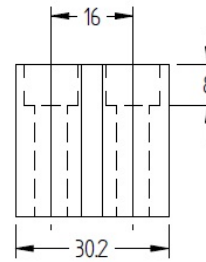

An optional adaptive shoe - for EP100/150 users

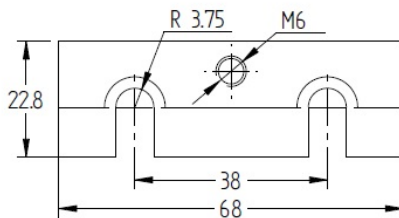

CSM150/300 is a new capacitor built with a new soldering technology that enables a better heat extraction and hence higher operating power of 300kVA<sub>r</sub>.

## Specifications

Type		CSM 150/300									
Dimensions (L x W x H)	mm	68 x 30.2 x 30									
Weight	kg	0.3									
Capacitance (±10%)	μF	0.05μF	0.1μF	0.17μF	0.33μF	0.5μF	0.66μF	1μF	1.33μF	2.4μF	
Sinusoidal Voltage	V <sub>rms</sub>	1000			800		700		600	500	
Peak Voltage	V	1410			1130		990		850	710	
Max. Current	A <sub>rms</sub>	300			400		450		500	600	
Max. Power	kVA <sub>r</sub>	300									
Freq Range @ Full Power	kHz	955-955	478-478	281-281	226-257	149-170	148-163	97-107	100-100	80-80	
Stray Inductance	nH	< 3									

**Celem Power Capacitors**

Produced: 03-09-2015

# CSM 150/300

Conduction-cooled capacitor

Technology Patented Worldwide

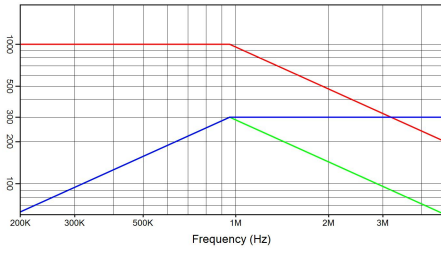

**CSM 150/300 0.05 µF 1000 V<sub>rms</sub> 300 A<sub>rms</sub> 300 kVA<sub>r</sub>**  
 I(A) — Q(kVA<sub>r</sub>) — V<sub>rms</sub> — 300 kVA<sub>r</sub>

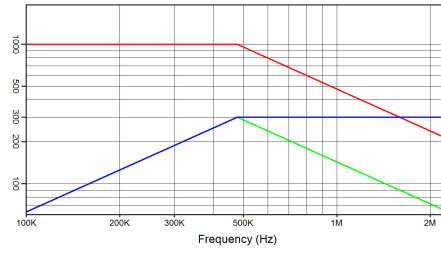

**CSM 150/300 0.1 µF 1000 V<sub>rms</sub> 300 A<sub>rms</sub> 300 kVA<sub>r</sub>**  
 I(A) — Q(kVA<sub>r</sub>) — V<sub>rms</sub> — 300 kVA<sub>r</sub>

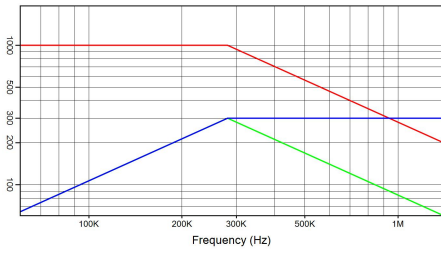

**CSM 150/300 0.17 µF 1000 V<sub>rms</sub> 300 A<sub>rms</sub> 300 kVA<sub>r</sub>**  
 I(A) — Q(kVA<sub>r</sub>) — V<sub>rms</sub> — 300 kVA<sub>r</sub>

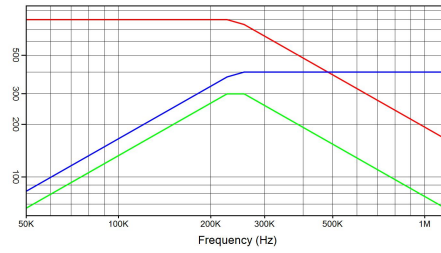

**CSM 150/300 0.33 µF 800 V<sub>rms</sub> 400 A<sub>rms</sub> 300 kVA<sub>r</sub>**  
 I(A) — Q(kVA<sub>r</sub>) — V<sub>rms</sub> — 300 kVA<sub>r</sub>

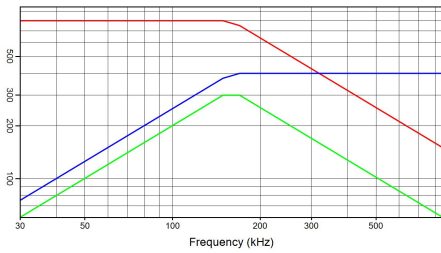

**CSM 150/300 0.5 µF 800 V<sub>rms</sub> 400 A<sub>rms</sub> 300 kVA<sub>r</sub>**  
 I(A) — Q(kVA<sub>r</sub>) — V<sub>rms</sub> — 300 kVA<sub>r</sub>

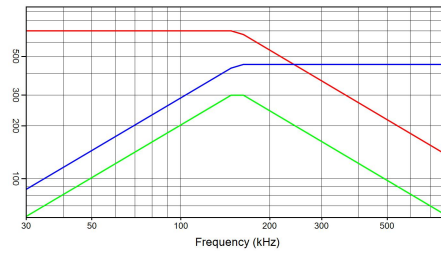

**CSM 150/300 0.66 µF 700 V<sub>rms</sub> 450 A<sub>rms</sub> 300 kVA<sub>r</sub>**  
 I(A) — Q(kVA<sub>r</sub>) — V<sub>rms</sub> — 300 kVA<sub>r</sub>

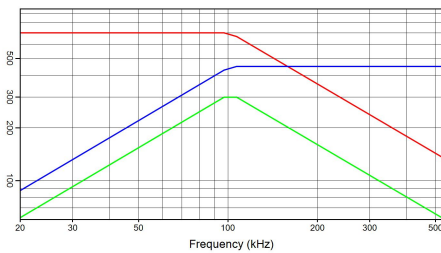

**CSM 150/300 1 µF 700 V<sub>rms</sub> 450 A<sub>rms</sub> 300 kVA<sub>r</sub>**  
 I(A) — Q(kVA<sub>r</sub>) — V<sub>rms</sub> — 300 kVA<sub>r</sub>

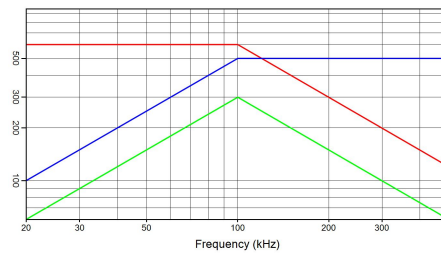

**CSM 150/300 1.33 µF 600 V<sub>rms</sub> 500 A<sub>rms</sub> 300 kVA<sub>r</sub>**  
 I(A) — Q(kVA<sub>r</sub>) — V<sub>rms</sub> — 300 kVA<sub>r</sub>

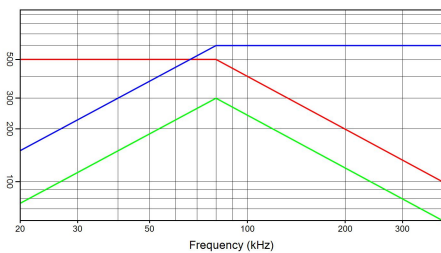

**CSM 150/300 2.4 µF 500 V<sub>rms</sub> 600 A<sub>rms</sub> 300 kVA<sub>r</sub>**  
 I(A) — Q(kVA<sub>r</sub>) — V<sub>rms</sub> — 300 kVA<sub>r</sub>

*Celem Power Capacitors*